

Accessories

Main Device	1Set
Power Adapter	1Piece
User Guide	1Volume
Wiring Terminals	2Pieces
Conversion Cable(Optional)	1Piece

Before using the device, ensure that all the accessories above are included in the package.

If you have any problems, please contact the services provider of the distributors.

7

Wall Mount Bracket Installation

1. Drill holes on the wall or other surface according to the mounting plate.
2. Use four supplied self-tapping screws to secure the mounting plate on the wall.
3. Route the cables through the cable hole of the mounting plate and bracket, and connect to the wiring terminals.
4. Plug the wiring terminals into the device and use four supplied M5 screws to secure the bracket on the device.
5. Align the device with the mounting plate and buckle them together, and use two supplied M3 screws to secure the device on the mounting plate.
6. Adjust the tilt angle of the device according to your actual needs.

※ Wall Mount Bracket is optional.

8

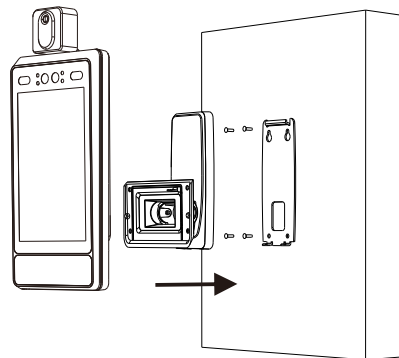

Device Bracket Mounting Plate Wall

Accessories	
Wall-mounting Bracket	1 Set
Mounting Plate	1 Piece
Wall Plug	4 Pieces
Self-tapping Screw	4 Pieces
M5 Screw	4 Pieces
M3 Screw	2 Pieces

9

Turnstile Mount Bracket Installation

1. Thread the cable through the nut, the cable holes on the turnstile pedestal's top panel, and route them through the bracket.
2. Wire the cable with the terminals in the turnstile pedestal.
3. Raise the bracket and make sure the bracket and the pedestal top panel are vertical.
4. Rotate the nut and secure the bracket.
5. Plug the wiring terminals into the device and use four supplied M5 screws to secure the bracket on the device.
6. Adjust the tilt angle of the device according to your actual needs.

※ Turnstile Mount Bracket is optional.

10

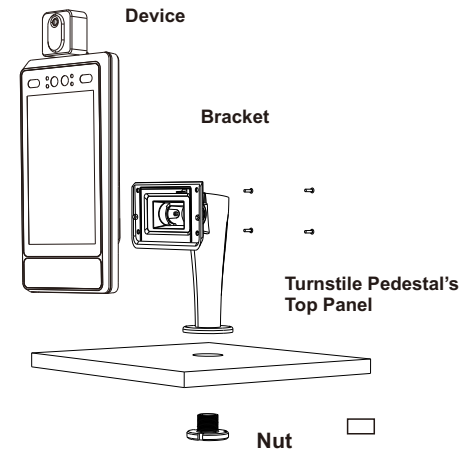

Accessories	
Turnstile Mount Bracket	1 Set
Nut	1 Piece
M5 Screw	4 Pieces

11

Telpeo | TPS980
Face Recognition
Temperature Measurement Terminal

User Guide

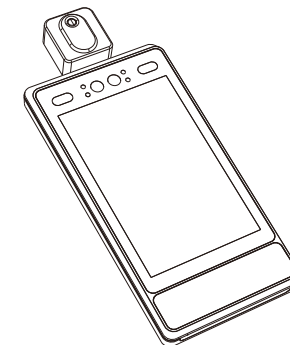

TPS980 Specification

Processor	<ul style="list-style-type: none"> ● Dual-Core 1.8GHz + Quad-Core 1.5GHz ○ Quad-Core 1.8GHz
Memory	<ul style="list-style-type: none"> ● 4GB RAM, 16GB FLASH ○ 2GB RAM, 16GB FLASH
OS	Android 7.1
Display	8-inch LCD Touch Screen, Resolution 1280*800
Camera	2M Pixel, support HDR <ul style="list-style-type: none"> ● Dual-lens Camera (RGB + IR) ○ Single-lens Camera (RGB) ○ 3D Depth Sensing Camera
Fill light	White LED
Contactless Card Reader	○ ISO14443 Type A/B, Mifare®, ISO18092 Compliant
SIM Slot	1 SIM
Communications	<ul style="list-style-type: none"> ● Ethernet/WiFi/Bluetooth ○ LTE
Peripheral Ports	DC Input × 1, Micro USB × 1, RJ45 × 1, Door Lock × 1, Wiegand × 1, RS485 × 1
Audio	Digital Audio Speaker, Microphone
Power Supply	12V/2A
Thermal imaging module	Temperature accuracy ±0.5°C , distance support 0.5 - 0.7m
Temperature	-10°C~45°C
Humidity	10%~90% (Non-Condensing)
Dimensions	272mm × 135mm × 30mm (Without bracket)

● Standard ○ Optional

Note: Reserve the right to change the parameters without prior notice.

1

Appearance

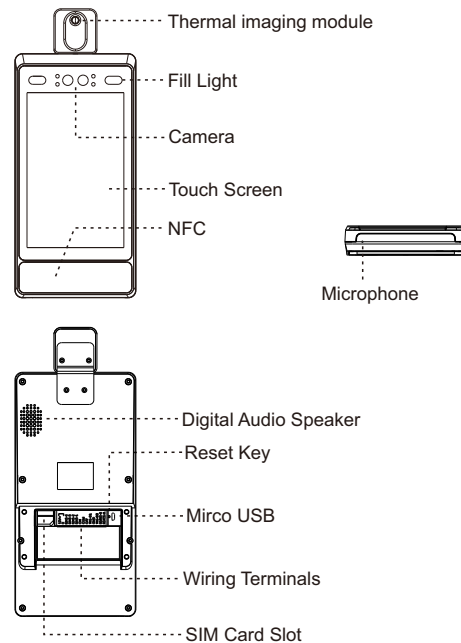

2

Terminal Descriptions

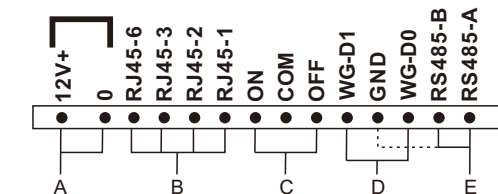

Group	Function	Color	Name
A	Power Input	Red (Thick) × 2	12V+
		Black (Thick) × 2	0
B	RJ45	Grey	RJ45-6
		Yellow	RJ45-3
		Orange	RJ45-2
		Brown	RJ45-1
C	Door Lock	Blue (Thick)	ON
		Green (Thick)	COM
		Yellow (Thick)	OFF
D	Wiegand	Blue	WG-D1
		Red	WG-D0
E	RS485	Black	GND
		Green	RS485-B
		White	RS485-A

Note: This is only used for the conversion cable provided by the manufacturer.

3

Terminal Connection

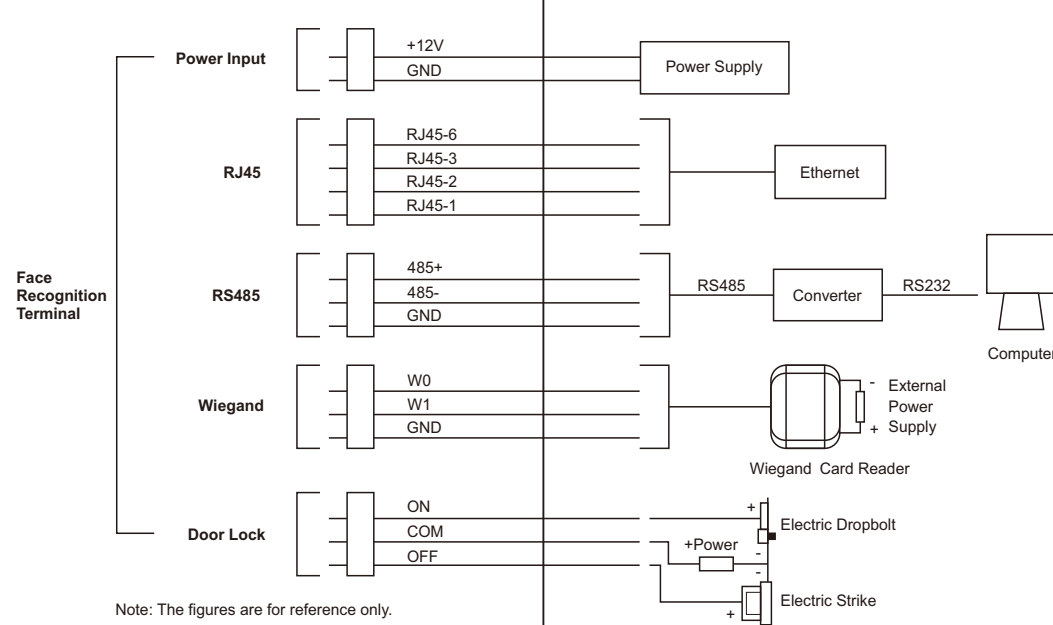

Note: The figures are for reference only.

4

5

SIM Card Installation

1. Push the SIM card into the socket correctly. Be sure the SIM card is in right direction.

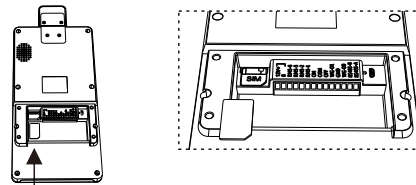

Boot

1. Wire the cable with the terminals.
2. Plug the wiring terminals into the device.
3. Connect the power adapter and wait for automatic boot.

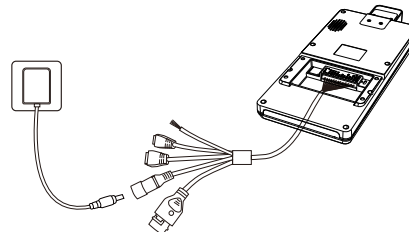

6